

Lead Screw

Linear actuation for positioning tasks
PRECiStep® Technology

For combination with
Stepper Motors: AM0820, AM1020, ADM1220S,
AM1524, AM2224-R3

Series M3 x 0,5 x L1

| | | |
|------------------|-----------------|----|
| Nominal diameter | 3,0 | mm |
| Pitch | 0,5 | mm |
| Material | Stainless steel | |

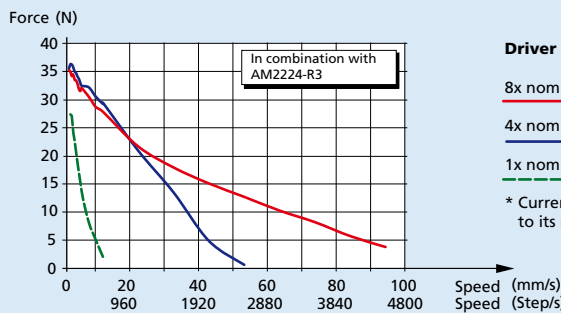
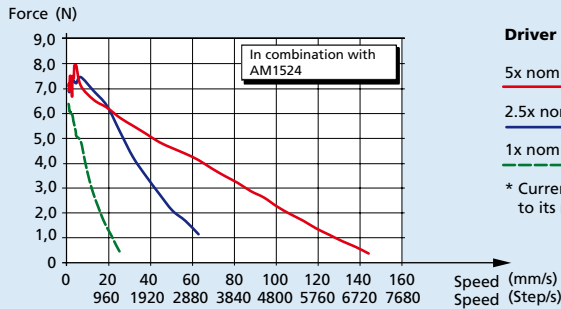

Important notes: The thrust curves include already a safety factor for the use of the stepper motor.
Please read the "Technical information" for a better understanding of the curves.

| Ordering information | L1 (mm) = | 15 | 25 | Custom |
|-------------------------------|-----------|------------|------------|-------------|
| Order code (no bearing tip) | | M3x0,5x15 | M3x0,5x25 | M3x0,5xL1* |
| Order code (with bearing tip) | | M3x0,5x15T | M3x0,5x25T | M3x0,5xL1*T |

* For custom length, please inquire with your point of sales

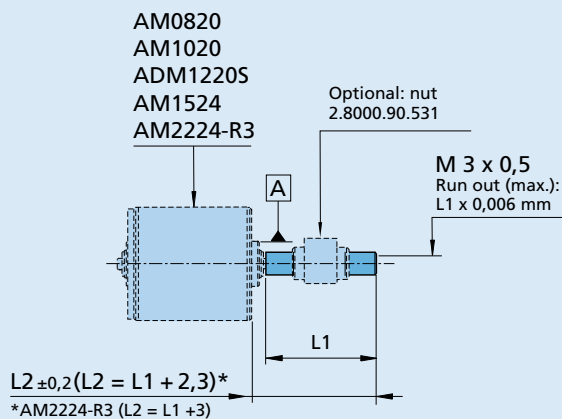

M3,0 x 0,5 x L1

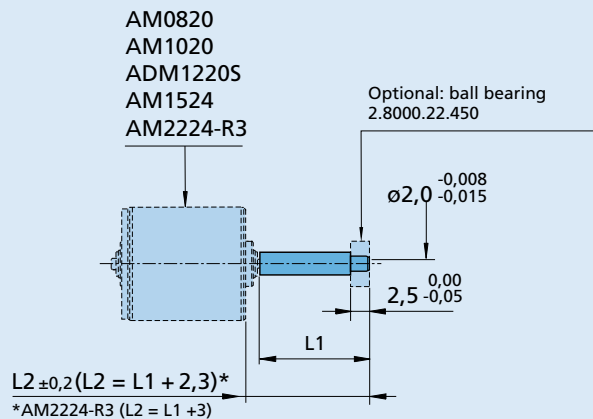

Version with bearing tip
M3,0 x 0,5 x L1 T

Lead Screw

Optional nuts and bearings
PRECIstep® Technology

Options

For M1,2 x 0,25 Lead screws

Scale 2:1 

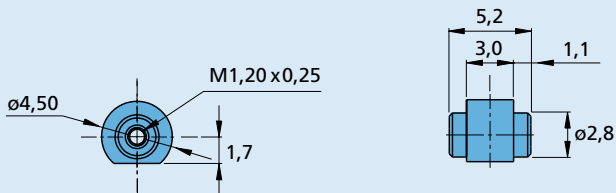

Nut Part No. 2.8000.08.351, Material CuAl10Ni5Fe4

For M1,6 x 0,35 Lead screws

Scale 2:1 

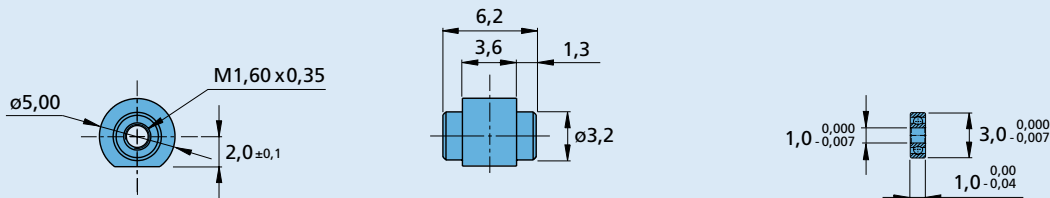

Nut Part No. 2.8000.90.510, Material CuAl10Ni5Fe4

Bearing for leadscrew tip Part No. 2.8000.08.401

For M2,0 x 0,2 Lead screws

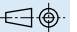
Scale 2:1 

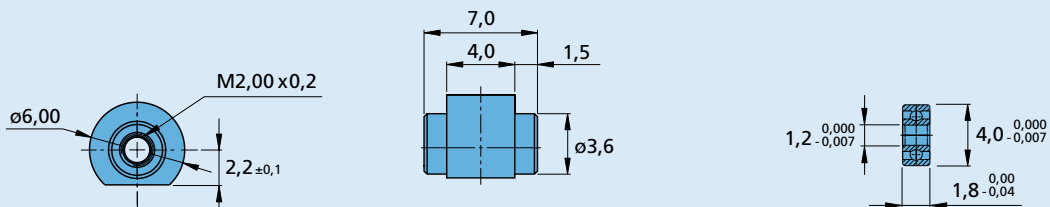

Nut Part No. 2.8000.08.353, Material CuAl10Ni5Fe4

Bearing for leadscrew tip Part No. 2.8000.10.401

For M2,5 x 0,25 Lead screws

Scale 2:1 

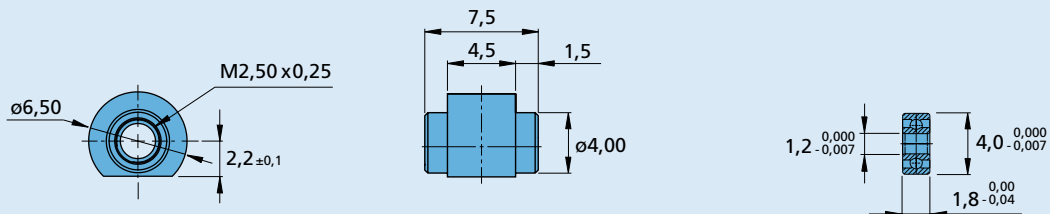

Nut Part No. 2.8000.90.511, Material CuAl10Ni5Fe4

Bearing for leadscrew tip Part No. 2.8000.10.401

For M3,0 x 0,5 Lead screws

Scale 2:1 

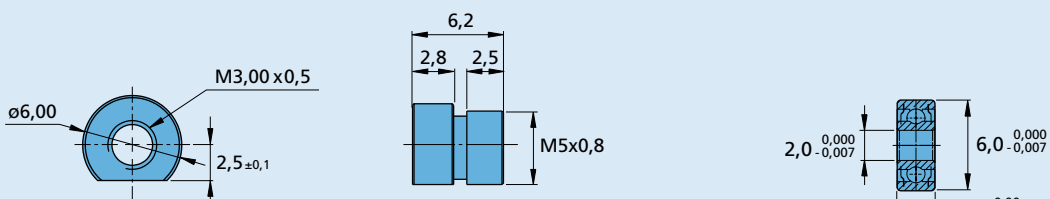

Nut Part No. 2.8000.90.531, Self-lubricating synthetics material

Bearing for leadscrew tip Part No. 2.8000.22.450